

Injection	Model	Unit	H1100		
Injection	Screw Diameter	mm	105	115	130
	Screw L/D Ratio	L/D	23	21	18.6
	Swept Volume	cc	4936	5921	7566
	Max shot Weight(P.S.)	g	4442	5329	6809
		oz	156	188	240
	Max Injection Pressure	bar	2235	1863	1458
	Max Injection Rate	g/sec	716	859	1098
Clamping	Screw Stroke	mm	570		
	Max Locking Force	tonne	1100		
	Max Opening Stroke	mm	2000		
	Min Mould Height	mm	600		
	Max Mould Height	mm	1300		
	Max Dayllght	mm	2600		
	Space between tie bars	mm	1150×1150		
	Diameter of tie bars	mm	210		
	Max Ejector forward Force	tonne	24.74		
	Max Ejector Stroke	mm	400		
General	Pump Drive Motor	kw(HP)	124kw/165hp		
	Hydraulic Pressure	bar	140		
	Heating Capacity	kw	4700×10 +1100W		
	Number of Heating Zones	qty	5+N		
	Oil Filling	liter	2000		
	Machine Dimensions(L×W×H)	m	10.5×2.9×3.2		
	Machine Weight	tonne	60		
	International	EUROMAP	11031	1100	

*Injection Weight=Calculated injection volume × gravity specific × 85%
 *We reserve the right to amend the above figure without prior notice

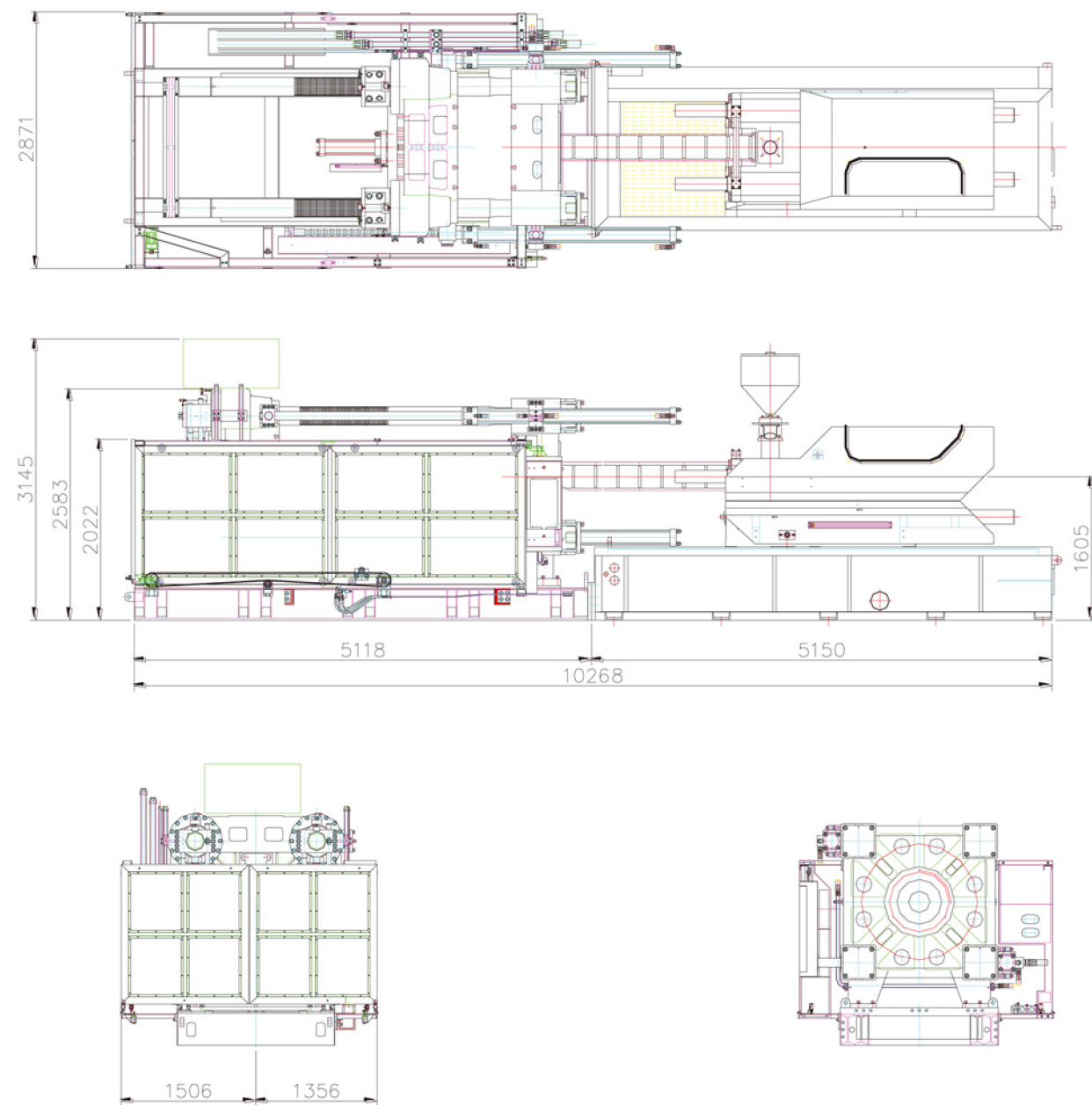

LIEN YU **EURO INJ[®]**



THE NEW INNOVATIONAL
2-PLATEN INJECTION MOLDING MACHINE

LARGE TONNAGE MACHINE H1100-H2300-TONS

TWO PLATENS



1 -Flexible opening stroke
Opening stroke is optioned to users
who required same clamping force.

2 -Safety guard driven by chain motor
will be fast and protect the operator.

3 -4 jaws are closed around the
tie bars which will effectively locking
the moving platen in position

4 -Long moving platen supporting beams
will be available to carry heavy mold.

5 -Rigid construction of fixed platen.

6 -The fast mold opening/closing is achieved
using 2 external small cylinders along with a
linear transducer for monitor his position.

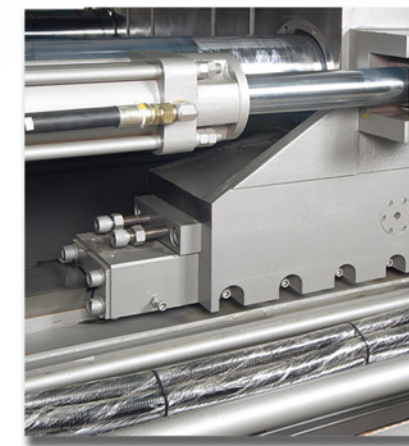
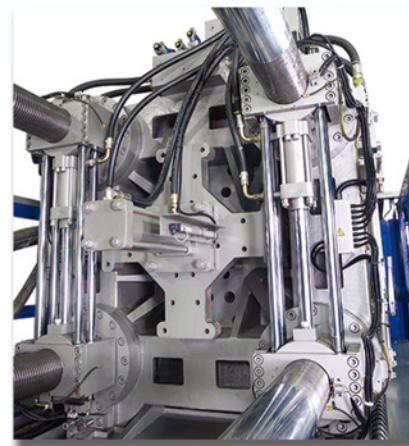
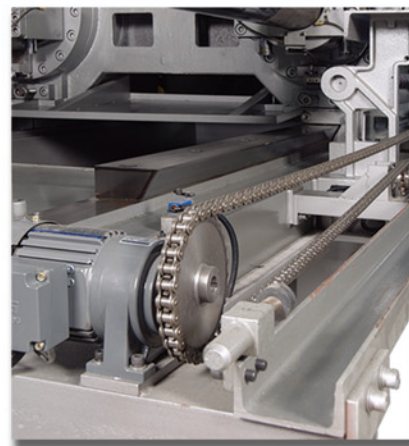

New innovation H-1100 two platens injection molding machine.

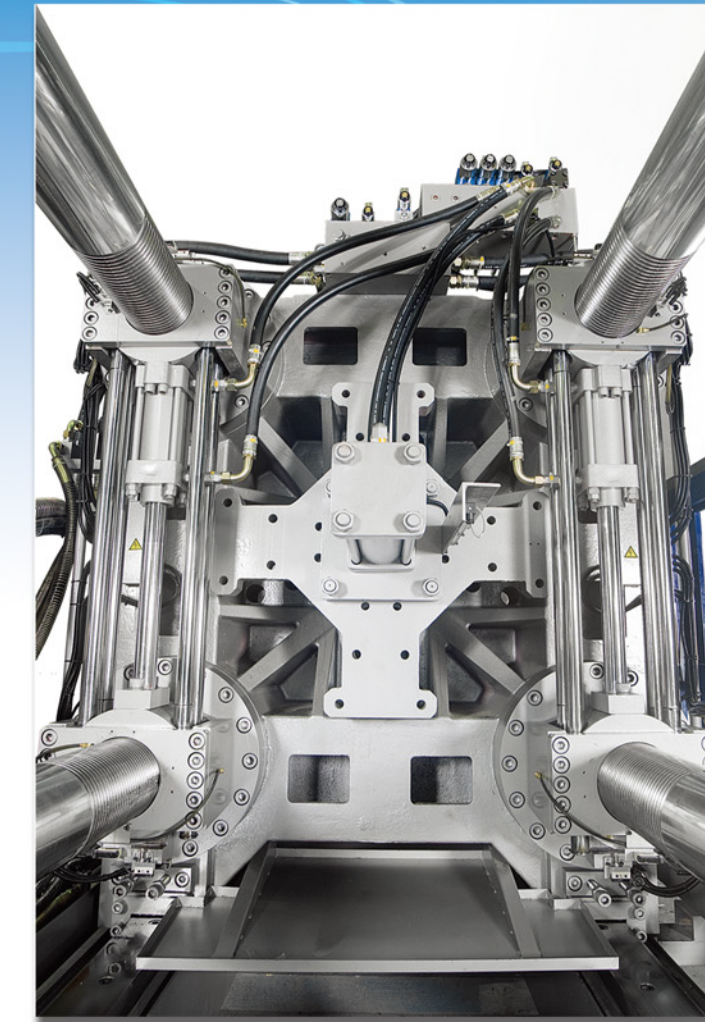

-Two-platen machine is popularly
accepted by Europe users for occupying
shorter layout space than traditional
toggle/or hydraulic machine. From
2.0meters in H1100 to 4.0meters in
H2300 clamping tonnages.

-Flexible opening stroke is welcome to
basket molding factory.

-Two-platen instituting three-platen and toggle set will light the machine's weight
and energy consumption.

-The fast mold opening/closing is achieved using 2 external small cylinders along
with a linear transducer for monitor his position.

-Once the mold is closed, the 4 jaws are closed around the tie bars which will effectively
locking the moving platen in position.

-The required clamping force is supplied by 4 big cylinders mounted inside the
moving platen. Each tie bar acts a piston pulling the moving platen towards fixed platen
with required force.

-Long moving platen supporting beams will be available to carry heavy mold which keep
the two platens in parallel absolutely.

-Rigid construction of fixed platen is strong enough to bear the deformation when
injection is processing.